

Blue Wave Stainless Steel Quick Fit Swageless Eye



Stainless steel quick fit swageless eye.

Swageless terminals, offer rapid termination of the wire no specialist tools are required, just a pair of spanners.

Suitable for wire types 1x19, 7x19, 7x7 and Dyform.

Stainless steel AISI 316.

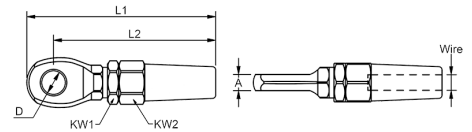

Part	D1 Wire mm	A mm	L2 mm	L1 mm	D mm	KW1 mm	KW2 mm	Break Load Kg.
BW-821903	3	5.5	50.1	58.6	6.5	13	12	750
BW-821904	4	7.0	60.4	71.4	8.5	13	14	1500
BW-821905	5	8.0	69.5	81.5	10.5	17	16	2180
BW-821906	6	9.0	82.0	96.0	13.0	19	19	3700
BW-821907	7	9.0	89.5	105.0	13.2	22	22	4700
BW-821908	8	10.0	100.5	117.0	14.5	24	24	5600
BW-821910	10	13.0	117.0	137.0	16.2	27	27	8300
BW-821912	12	15.0	139.5	161.0	19.5	32	32	12000
BW-821914	14	18.0	161.6	187.6	23.0	36	36	14000
BW-821916	16	20.0	185.0	214.0	26.0	41	41	23000